

Wire-probe sensor GM Series

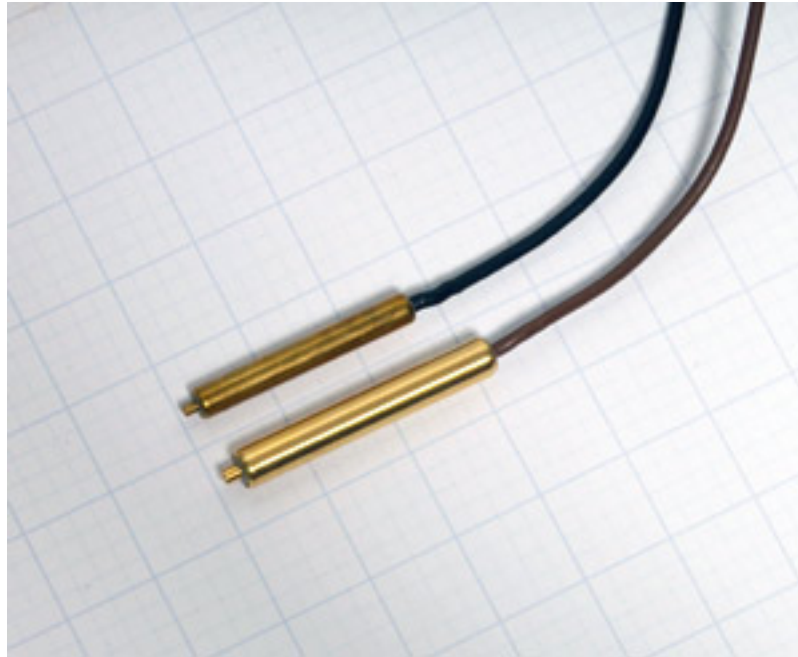

Application

In touch with a grounded part (die, stamping strip) the wire probe detects a negative (low) switching signal. The sensor can be used for checking part position or riveted bolt (see applications). With two wire probes it's also possible to make a dimensional check.

Technical features

- Exactly switching
- Metal housing
- Simply installation
- No electronic necessary
- One wire cable



TRsystems GmbH
Freiburger Str. 3
D-75179 Pforzheim

Tel +49(0)7231/3152-0
Fax +49(0)7231/3152-99
unidor@trsystems.de
www.trsystems.de

Wire-probe sensor GM Series



Technical Data

Spring deflection:	1,5mm
Sizes:	4mm – 8mm
Cable length:	2,5m w/o plug
Output:	n-switching
Operating temperature	0 °C... +40 °C
Housing:	Brass

Dimensions

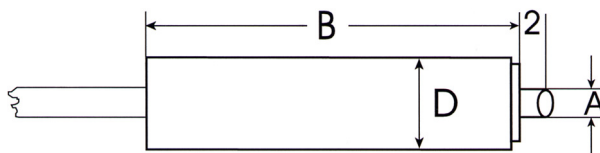

Type	A	B	D
GM 04	1,5mm	28mm	4mm
GM 08	3,0mm	33mm	8mm

Checking for part position

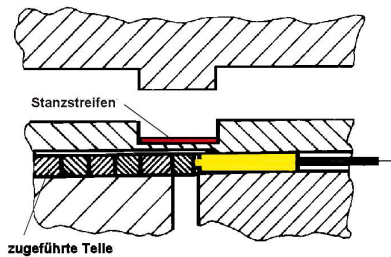

Checking for riveted bolt

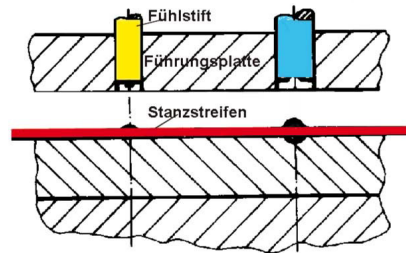

Order Data

Article-No.	Short term	Description
500701010000	Wire probe GM 04	Wire probe GM 04 w/o plug and 2,5m cable
500701040000	Wire probe GM 08	Wire probe GM 08 w/o plug and 2,5m cable

TRsystems GmbH
Freiburger Str. 3
D-75179 Pforzheim

Tel +49(0)7231/3152-0
Fax +49(0)7231/3152-99
unidor@trsystems.de
www.trsystems.de